



Master Developer



BUILDERS & DEVELOPERS

RAFAT RESIDENCY

**2, 3 & 4 Rooms Apartment
& Commercial Shops**

**7
MALIR**



RAFAT RESIDENCY

2, 3 & 4 Rooms Apartment
& Commercial Shops

7
MALIR



BUILDING ELEVATION





RAFAT RESIDENCY

2, 3 & 4 Rooms Apartment

7

MALIR



0%

Booking

Type A 845 SQFT

(4 Rooms Apartment)



Description	Amount
Monthly Installment @ (55,000x84)	4,620,000
Half Yearly Installment @ (185,000x14)	2,590,000
On Possession	790,000
Total Cost	8,000,000

Documentation charges: 15,000/.

Extra Charges: First to Second Floor @ 200,000

Corner 10%

West Open 5%

Road Facing 5%

Important Notes:

- 1- Documentation charges for lease and connection charges for Gas, Electricity, Water Sewerage charges will be charged extra when demanded by the company as these charges are excluded from the above mentioned cost.
- 2- All installments must be deposited before the 10th of each month.
- 3- The terms and Conditions in the Application form constituting the basis of this payment schedule and the buyer undertakes to abide by the same.
- 4- 10% discount on full cash payment at the time of booking.

Name: _____
Contact No: _____
Unit No: _____
Total Cost: _____

Read, Understood &
Accepted



Applicant Signature

Type A 845 SQFT (4 Rooms Apartment)





3D ELEVATIONS HOUSE

ARCHITECTURE

PLANNING

INTERIOR EXTERIOR

03225769262

WWW.3DELEVATIONSHOUSE.COM

ARCHITECT



RAFAT RESIDENCY

2, 3 & 4 Rooms Apartment

7

MALIR



0%

Booking

Type B 600 SQFT

(3 Rooms Apartment)



Description	Amount
Monthly Installment @ (45,000x84)	3,780,000
Half Yearly Installment @ (100,000x14)	1,400,000
On Possession	320,000
Total Cost	5,500,000

Documentation charges: 15,000/.

Extra Charges: First to Second Floor @ 200,000

Corner 10%

West Open 5%

Road Facing 5%

Important Notes:

- 1- Documentation charges for lease and connection charges for Gas, Electricity, Water Sewerage charges will be charged extra when demanded by the company as these charges are excluded from the above mentioned cost.
- 2- All installments must be deposited before the 10th of each month.
- 3- The terms and Conditions in the Application form constituting the basis of this payment schedule and the buyer undertakes to abide by the same.
- 4- 10% discount on full cash payment at the time of booking.

Name: _____
Contact No: _____
Unit No: _____
Total Cost: _____

Read, Understood &
Accepted



Applicant Signature

Type B 600 SQFT (3 Rooms Apartment)







RAFAT RESIDENCY

2, 3 & 4 Rooms Apartment

7

MALIR



0%

Booking

Type C 435 SQFT

(2 Rooms Apartment)



Description	Amount
Monthly Installment @ (30,000x84)	2,520,000
Half Yearly Installment @ (75,000x14)	1,050,000
On Possession	430,000
Total Cost	4,000,000

Documentation charges: 15,000/.

Extra Charges: First to Second Floor @ 200,000

Corner 10%

West Open 5%

Road Facing 5%

Important Notes:

- 1- Documentation charges for lease and connection charges for Gas, Electricity, Water Sewerage charges will be charged extra when demanded by the company as these charges are excluded from the above mentioned cost.
- 2- All installments must be deposited before the 10th of each month.
- 3- The terms and Conditions in the Application form constituting the basis of this payment schedule and the buyer undertakes to abide by the same.
- 4- 10% discount on full cash payment at the time of booking.

Name: _____
Contact No: _____
Unit No: _____
Total Cost: _____

Read, Understood &
Accepted

Applicant Signature

Type C 435 SQFT (2 Rooms Apartment)





3D ELEVATIONS HOUSE

ARCHITECTURE

PLANNING

INTERIOR EXTENSIVE

03235769262

www.3dhousearchitecture.com

ARCHITECT

EVERMOTION

Typical Floor Plan (A-845, B-600 & C-435 Apartments)

RAFAT RESIDENCY-07

MAIN ROAD





3D ELEVATIONS HOUSE

ARCHITECTURE
PLANNING

INTERIOR EXTERIOR

0332789965

www.3delevationshouse.com

ARCHITECT



RAFAT RESIDENCY

Commercial Shops

7

MALIR



0%

Booking

Payment Schedule

(Shops)



Description	Amount
84 Monthly Installment Plan	Rs.
14 Half Yearly Installment Plan	Rs.
On Possession	Rs.
Total Cost	Rs.

198 SQFT ☐

165 SQFT ☐

130 SQFT ☐

108 SQFT ☐

Documentation charges: 15,000/.

Extra Charges: First to Second Floor @ 200,000

Corner 10%

West Open 5%

Road Facing 5%

Important Notes:

- 1- Documentation charges for lease and connection charges for Gas, Electricity, Water Sewerage charges will be charged extra when demanded by the company as these charges are excluded from the above mentioned cost.
- 2- All installments must be deposited before the 10th of each month.
- 3- The terms and Conditions in the Application form constituting the basis of this payment schedule and the buyer undertakes to abide by the same.
- 4- 10% discount on full cash payment at the time of booking.

Name: _____

Contact No: _____

Unit No: _____

Total Cost: _____

Read, Understood &
Accepted



Applicant Signature

Floor Plan

(198, 165, 130 & 108 SQFT Shops)

Ground + Basement

RAFAT RESIDENCY-07

MAIN ROAD



GROUND FLOOR PLAN

24'-0" WIDE ROAD

MAIN ROAD

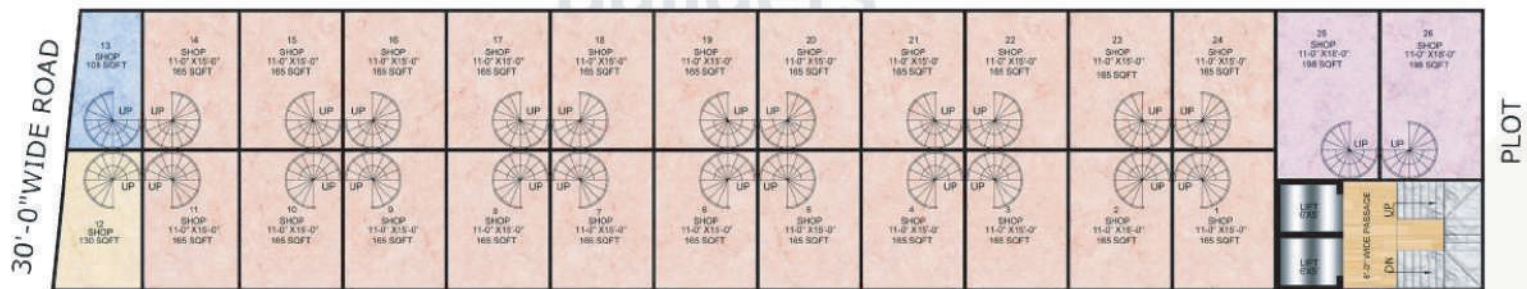

BASEMENT FLOOR PLAN

24'-0" WIDE ROAD



3D ELEVATIONS HOUSE

ARCHITECTURE

PLANNING

INTERIOR EXTERIOR

03325769965

www.3delevationshousearchitect.com

ARCHITECT



RAFAT RESIDENCY

2 , 3 & 4 Rooms Apartment
& Commercial Shops

7
MALIR



LOCATION MAP

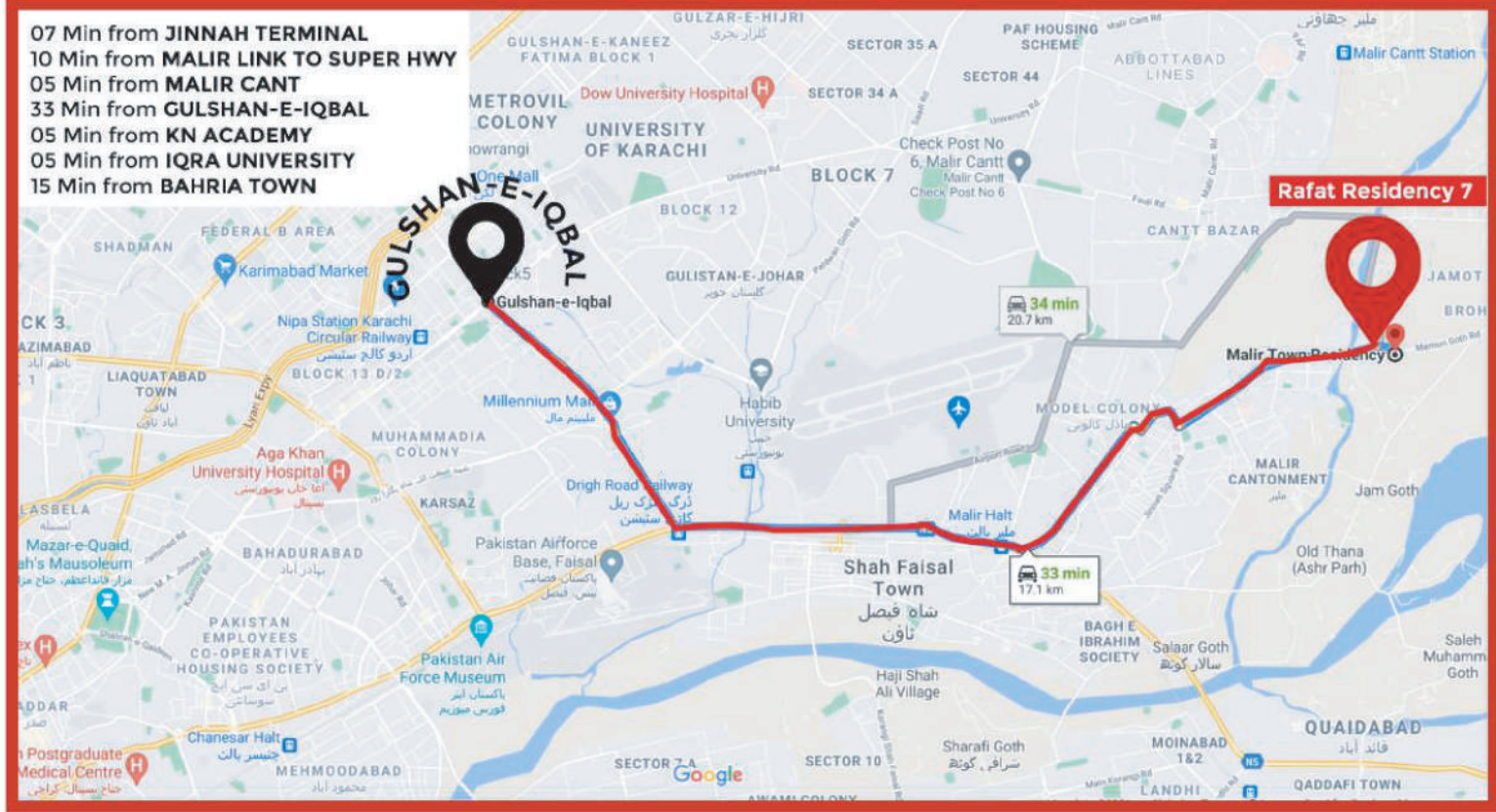

RAFAT RESIDENCY 7 MALIR

Malir Town Residency phase 5 Plot # 35-39
Karachi, Pakistan

CONTACT US FOR MORE INFO
0317-7333222, 0317-7999222
& 0340-3334677

